

Aluminum Punkah Louver -Round Duct Series

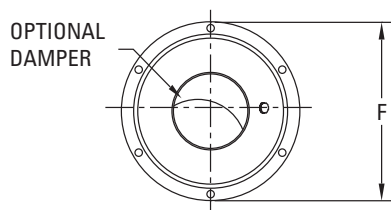
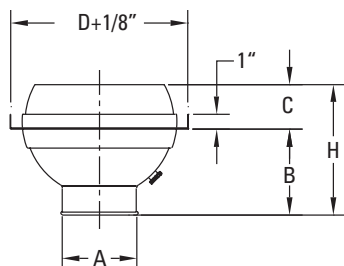

HIGH VELOCITY TASK AIR OUTLET

- Low Noise Levels
- Low Pressure Requirements

ADJUSTABILITY

- Easy Finger Tip Adjustment
- Directional Air Pattern Control:
70 Degree Global Rotation Minimum
±35 Degree Deflection
360 Degree Rotation

INSTALLATION

- Mounts Cleanly to Exposed Ductwork

MODEL	SIZE	A	B	C	D	F	H
APL-04/04A-RD	4	2	2-9/16	3/4	6	6	3-5/16
APL-06/06A-RD	6	3	3-1/16	1-7/16	8	8	4-1/2
APL-08/08A-RD	8	4-3/8	4-1/4	1-3/4	10	10	6
APL-10/10A-RD	10	5-3/4	5-1/2	2-7/8	12	12	8-3/8
APL-12/12A-RD	12	7-3/8	6	3	14	14	9
APL-14/14A-RD	14	8-5/8	7-1/8	4-1/8	16	16	11-1/4
APL-16/16A-RD	16	9-3/4	8-1/4	4-3/4	18	18	13
APL-18/18A-RD	18	10-1/2	9-1/2	4-1/4	20	20	13-3/4
APL-20/20A-RD	20	12-3/8	10-7/8	4-7/8	22	22	15-3/4

Inches measured to the nearest 1/16 inch

STANDARD FINISH:

- #10 Clear Anodized
- #42 Gloss Black Powder Coat
- #52 White Powder Coat
- #72 Silver Metallic Powder Coat
- #00 Mill Aluminum

OPTIONS:

- Aperture Damper
- Custom Finish _____

MATERIAL:

- Aluminum
- Stainless Steel Damper Hardware

NOTES:

- Frame Slides Cleanly Over End of Exposed Ductwork
- Mounting Screws Included
- "A" in Model Name Designates Aperture Damper Required

Project:	APL Series Aluminum Punkah Louver - Round Duct Series	
Architect:		
Engineer:		
Contractor:	Form No: 20013S	
Submitted By:	Date:	Drawn By: MH January 2005