



AIRCONCEPTS

AIR DISTRIBUTION PRODUCTS



AN SERIES

ANF/ANR

ANF
Wall/Ceiling Mount

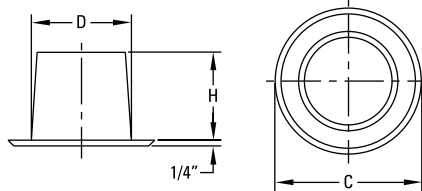

ANR
Wall/Ceiling Mount

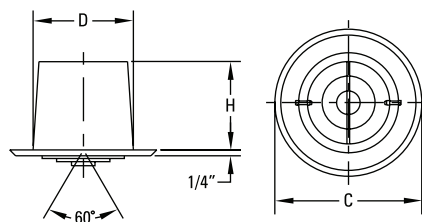

ANF Dimensions in Inches

MODEL	D	C	H
ANF-03	3	5 1/4	3 1/2
ANF-04	4	6 1/4	3 1/2
ANF-05	5	7 1/4	4
ANF-06	6	8 1/4	2 1/4
ANF-08	8	10 1/4	2 1/4
ANF-10	10	12 1/4	2 1/4
ANF-12	12	14 1/4	2 1/4
ANF-14	14	16 1/4	2 1/4
ANF-16	16	18 1/4	2 1/4

ANR Dimensions in Inches

MODEL	D	C	H
ANR-03	3	5 1/4	3 1/2
ANR-04	4	6 1/4	3 1/2
ANR-05	5	7 1/4	4
ANR-06	6	8 1/4	2 1/4
ANR-08	8	10 1/4	2 1/4
ANR-10	10	12 1/4	2 1/4
ANR-12	12	14 1/4	2 1/4
ANR-14	14	16 1/4	2 1/4
ANR-16	16	18 1/4	2 1/4

MODEL	Duct Velocity (FPM) Velocity Pressure	400	600	800	1000	1200	1400	1600
		0.01	0.022	0.04	0.062	0.089	0.122	0.16
ANF/ANR-03	CFM	20	29	39	49	59	69	79
ANF-03	Total Pressure	0.012	0.026	0.047	0.074	0.106	0.144	0.188
ANF-03	NC	<15	<15	<15	<15	17	21	25
ANR-03	Total Pressure	0.016	0.036	0.064	0.100	0.144	0.196	0.256
ANR-03	NC	<15	<15	<15	16	21	25	29
ANF/ANR-03	Projection	1-3-7	2-5-10	3-7-12	5-9-13	6-10-14	6-11-16	7-12-17
ANF/ANR-04	CFM	35	52	70	87	105	122	140
ANF-04	Total Pressure	0.012	0.026	0.047	0.076	0.106	0.144	0.188
ANF-04	NC	<15	<15	<15	19	23	27	31
ANR-04	Total Pressure	0.016	0.036	0.064	0.100	0.144	0.196	0.256
ANR-04	NC	<15	<15	16	22	28	32	36
ANF/ANR-04	Projection	2-4-10	3-7-14	4-10-16	6-12-18	7-14-19	9-15-21	10-13-18

performance data based on ASHRAE 70-06

Adjustability

Easy Finger Tip Adjustment
Directional Air Pattern Control:
±30° Degree Deflection

Construction

Aluminum Cone
Steel Core

Finishes

Standard: #52 White powder coat
Optional standard: #00 Mill (Alum)
#10 Clear anodized (Alum)
#12 Anodized powder coat
#42 Gloss black powder coat
#43 Flat black powder coat
#62 Grey prime powder coat
#72 Silver metallic powder coat
Custom colors available

MODEL	Duct Velocity (FPM) Velocity Pressure	400 0.01	600 0.022	800 0.04	1000 0.062	1200 0.089	1400 0.122	1600 0.16
ANF/ANR-05	CFM	55	82	109	136	164	191	218
ANF-05	Total Pressure	0.012	0.026	0.047	0.074	0.106	0.144	0.188
ANF-05	NC	<15	<15	16	22	27	31	35
ANR-05	Total Pressure	0.016	0.036	0.064	0.100	0.144	0.196	0.256
ANR-05	NC	<15	<15	21	28	33	37	41
ANF/ANR-05	Projection	2-5-11	3-6-15	5-10-20	8-13-22	9-15-24	11-18-26	12-16-23
ANF/ANR-06	CFM	79	118	157	196	236	275	314
ANF-06	Total Pressure	0.012	0.026	0.047	0.074	0.106	0.144	0.188
ANF-06	NC	<15	<15	20	26	31	35	39
ANR-06	Total Pressure	0.016	0.036	0.064	0.100	0.144	0.196	0.256
ANR-06	NC	<15	17	25	32	37	42	46
ANF/ANR-06	Projection	4-8-15	5-11-20	6-15-24	9-18-26	11-20-29	13-22-31	15-24-33
ANF/ANR-08	CFM	140	210	280	350	420	490	560
ANF-08	Total Pressure	0.012	0.029	0.052	0.08	0.116	0.158	0.207
ANF-08	NC	<15	<15	<15	15	20	25	29
ANR-08	Total Pressure	0.017	0.039	0.07	0.109	0.157	0.214	0.28
ANR-08	NC	<15	<15	15	20	25	30	34
ANF/ANR-08	Projection	5-11-23	8-17-28	11-23-32	14-25-36	17-28-39	20-30-42	23-32-45
ANF/ANR-10	CFM	218	327	436	545	654	763	872
ANF-10	Total Pressure	0.012	0.029	0.052	0.08	0.116	0.158	0.207
ANF-10	NC	<15	<15	<15	17	22	27	31
ANR-10	Total Pressure	0.017	0.039	0.07	0.109	0.157	0.214	0.28
ANR-10	NC	<15	<15	17	22	27	32	36
ANF/ANR-10	Projection	7-14-28	11-21-34	14-28-40	18-31-44	21-34-49	25-37-53	28-40-56
ANF/ANR-12	CFM	314	471	628	785	942	1100	1256
ANF-12	Total Pressure	0.012	0.029	0.052	0.08	0.116	0.159	0.207
ANF-12	NC	<15	<15	<15	17	23	27	32
ANR-12	Total Pressure	0.017	0.039	0.07	0.109	0.157	0.215	0.28
ANR-12	NC	<15	<15	19	23	29	33	38
ANF/ANR-12	Projection	8-17-34	13-25-41	17-34-48	21-38-53	25-41-58	30-45-63	38-54-76
ANF/ANR-14	CFM	428	641	855	1069	1283	1497	1710
ANF-14	Total Pressure	0.012	0.029	0.052	0.08	0.117	0.158	0.207
ANF-14	NC	<15	<15	<15	19	24	29	33
ANR-14	Total Pressure	0.017	0.039	0.07	0.109	0.158	0.214	0.28
ANR-14	NC	<15	15	20	25	30	35	39
ANF/ANR-14	Projection	9-20-39	15-30-48	20-39-56	25-44-62	30-48-68	35-52-74	39-56-79
ANF/ANR-16	CFM	558	838	1117	1396	1675	1954	2234
ANF-16	Total Pressure	0.012	0.029	0.052	0.08	0.117	0.158	0.207
ANF-16	NC	<15	<15	<15	19	25	30	34
ANR-16	Total Pressure	0.017	0.039	0.07	0.109	0.158	0.214	0.28
ANR-16	NC	<15	15	20	25	31	36	40
ANF/ANR-16	Projection	11-23-45	17-34-55	23-45-64	28-50-71	34-55-78	39-60-84	45-64-90

performance data based on ASHRAE 70-06

Airflow CFM: Standard air density and isothermal conditions.

Noise Criteria: Noise criteria [NC] curve which is not exceeded with a Room Attenuation of 10db and based on Sound Power Level Re: 10-12 watts.

Total Pressure: Inches of water gauge required.

Projection: Projection distance [THROW] in feet from the Nozzle discharge at which the maximum velocity has been reduced to specified terminal velocity [Vt].

Nozzle Velocity: Nozzle Discharge Velocity in feet per minute [fpm].

Terminal Velocity: Maximum velocity [Vt] in feet per minute at the specified distance from the outlet face [THROW] 200 fpm, 100 fpm, and 50 fpm respectively.